

08/25/2022

## Runway and Taxiway Shoulder Construction

### SBD Airport Tenants and Users,

The Airport has two construction projects coming up that will require airfield surface closures; **1. RWY Joint Seal Replacement** and **2. Taxiway Shoulder Improvement**.

1. The RWY project consists of pavement joint seal replacement and spall repair on the full length of the runway.
2. The shoulder project consists of multiphase taxiway shoulder improvements on several taxiway shoulders.

These construction projects will commence simultaneously and be scheduled in phases to minimize impact to aircraft operations. The attached diagrams below reference the areas.

### **Construction is scheduled to begin September 7, 2022.**

Starting on the 7<sup>th</sup>, Runway 06-24 will be closed Monday- Friday from 2200L to 0600L for joint seal replacement. The Taxiway Shoulder Improvement Project will start on the same date and consist primarily of daytime work occurring in phases to minimize operational impact on aircraft traffic on the airport movement areas.

Phase 1 of the Taxiway Shoulder improvement project requires the closure of Taxiway A between the West ramp and the approach end of runway 6 for approximately **16** calendar days.

The following Taxiways will also be closed 24/7 for the duration of the Runway Joint Seal Replacement Project:

- TWY A1 between RWY 06-24 and TWY A
- TWY E between RWY 06-24 and TWY A
- The North 450 feet of TWY F

Airport Operations will provide details for these projects in future memos when phase changes occur.

If you have any questions or concerns, don't hesitate to contact Airport Operations at (909) 382-2382.

## TWY Shoulder Improvement Project Overview

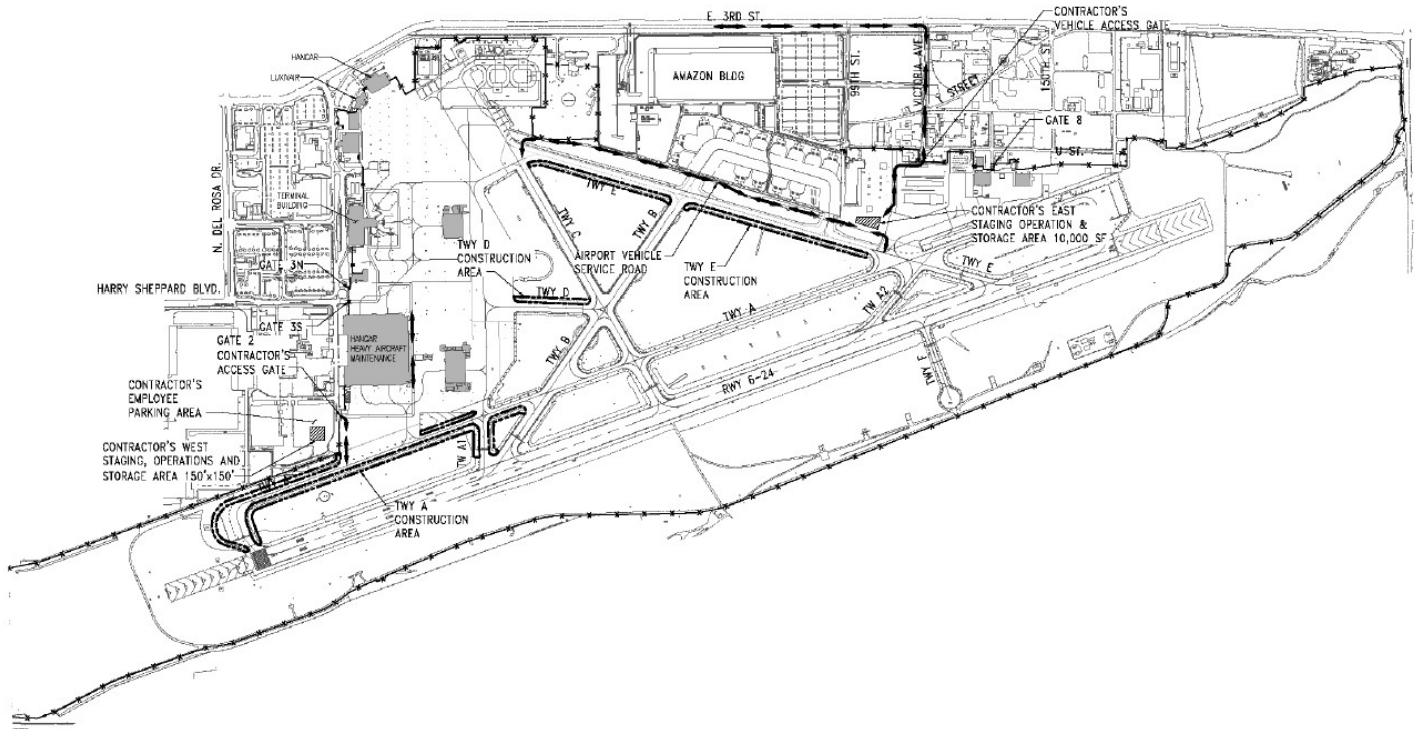

## Taxiway Shoulder Improvement Project Phase 1

